

ofeliadorme - technical rider 2017

• BACKLINE AND NOTE
<b>BACKLINE:</b>
Drums: 1 kick ø20", 1 snare ø14", 1 hit-hat 13", 1 ride 20", kick pedal, stands and stool
Guitar amp: Orange AD30 (30W head) + cabinet (2x12")
Bass amp: Fender Rumble 100 (combo+D.I.)
Synths: 3 stands

NOTE:
<b>CONTACTS FOR TECHNICAL INFO:</b>
mobile: Michele +39 392 2563102
mail: ofeliadorme@gmail.com
<b>OUTBOARD:</b>
DBX 166 or similar compressor/gate
<b>ON STAGE:</b>
3 Stage monitor on three lines (for big stage link the monitor 2 and 3 with the other two monitors) 1 more stand for mic <b>1 more XLR cable to connect the TC Helicon VoiceLive Play fx pedal</b>
<b>REQUIRED AT LEAST 60 MINUTES OF SOUNDCHECK</b> Since the stage and the outboard is completely connected and working perfectly.

• CHANNEL LIST							
Channel	Instrument	Mic	Note	Outboard	Send Monitor 1	Send Monitor 2	Send Monitor 3
1.	Kick	AKG D112		Gate*		.	
2.*	Snare top	Shure SM57		Gate*			
3.*	Snare bottom	Shure SM57		Gate*			
4.	O.H.	AKG 414					
5.	Electronic Drums L		D.I. Box		..	..	..
6.*	Electronic Drums R		D.I. Box		..	..	..
7.	Synth Bass	AKG D112	or D.I. Box			.	.
8.	Synth 2 L		XLR out		.	..	...
9.	Synth 2 R		XLR out		.	..	...
10.*	Guitar	Shure SM57				..	.
11.	Synth 1 L		D.I. Box		.	..	.
12.*	Synth 1 R		D.I. Box		.	..	.
13.	Vox	Shure SM58	w/FX pedal	Gate/Compressor*	..	...	..

\* Deleted this 5 channels for smaller venues/stages: ch2, ch3, ch6, ch10 ch12 and compressor/gate.

• STAGE PLAN

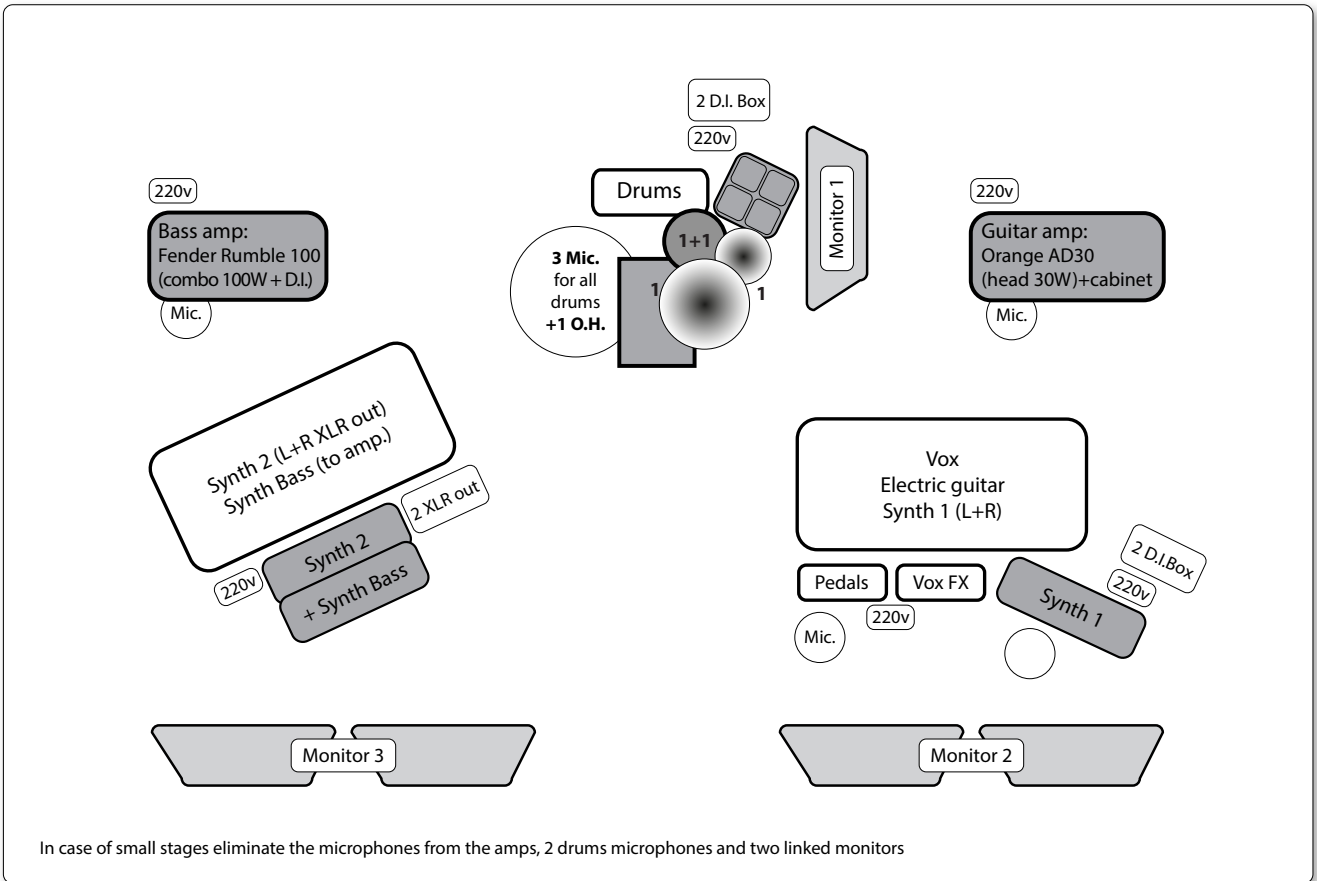

ofeliadorme - stage plane #1

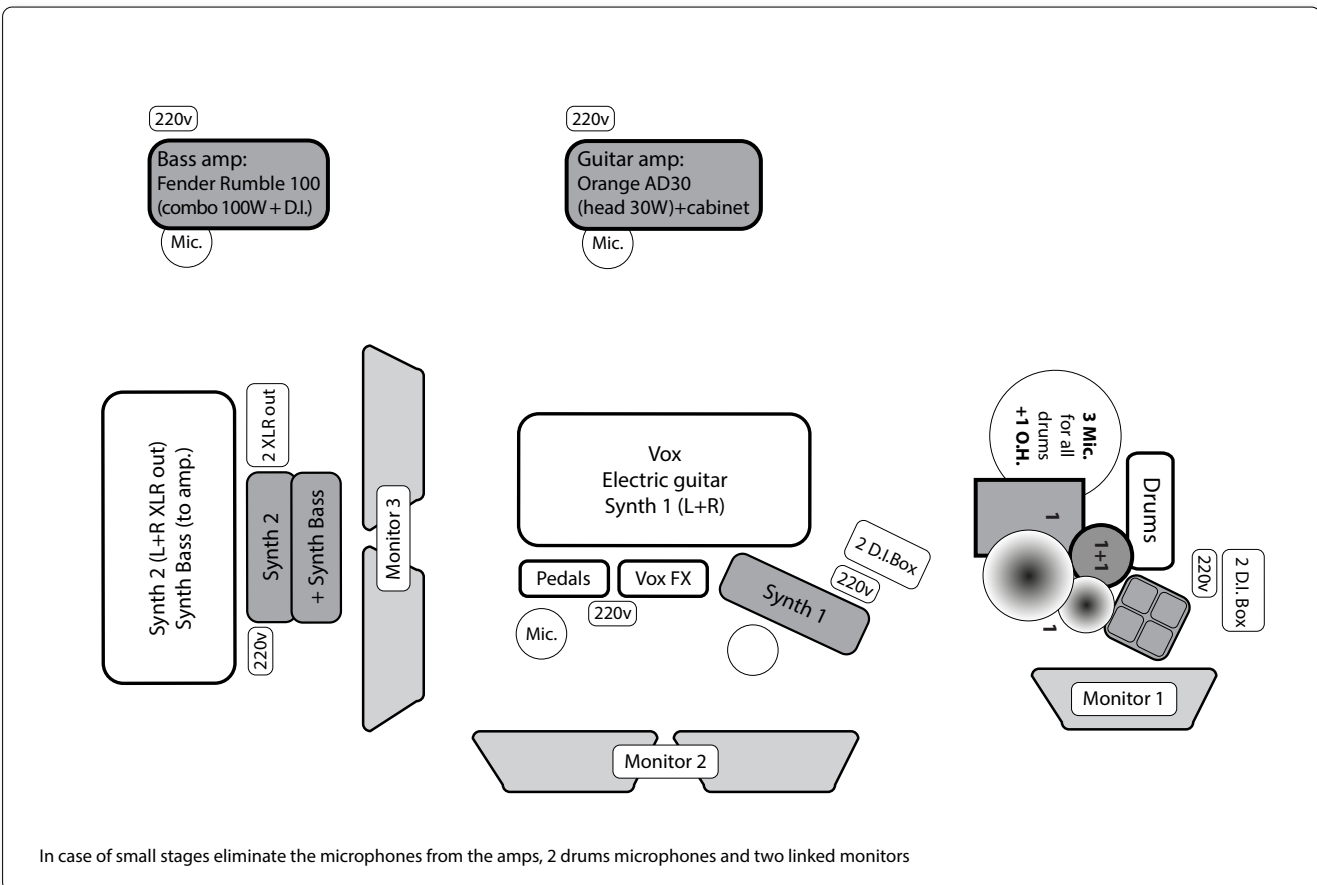

ofeliadorme - stage plane #2